

PER FLUIDI GRUPPO 2 - reg. CE 1272/2008

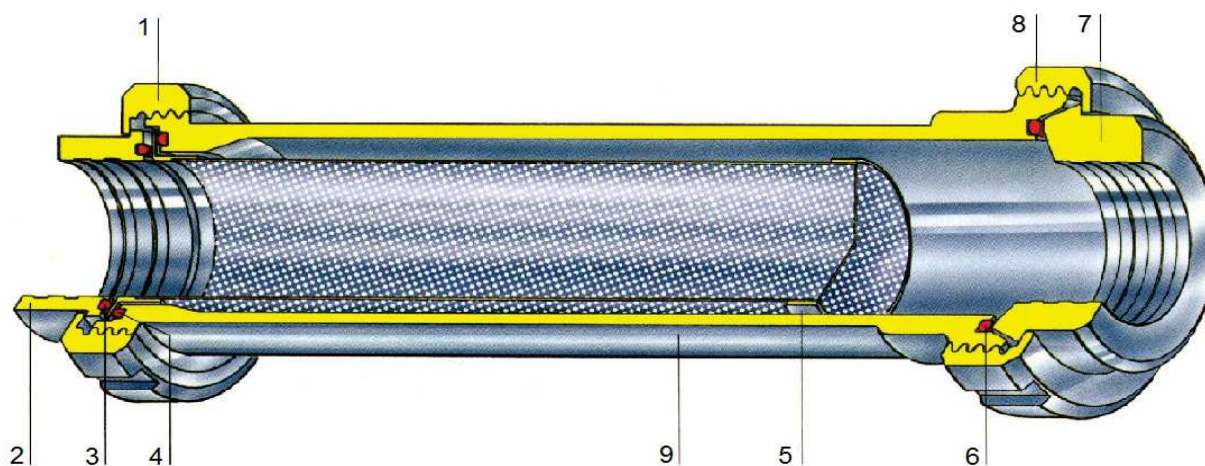

Part	Mat.	Descrizione - Description - Description - Beschreibung
1	Aisi 304/316	Girella - Nut - Ecrou - Nutmutter
2	Aisi 304/316	Attacco entrata - Enter connection - Bout d'entrée - Verbindungsstück Eingang
3	NBR/EPDM/SIL /FKM	Guarnizione - Seal ring - Joint - Dichtring (NBR/EPDM/SIL/VIT)
4	NBR/EPDM/SIL /FKM	Guarnizione - Seal ring - Joint - Dichtring (NBR/EPDM/SIL/VIT)
5	Aisi 304/316	Cestello filtrante - Strainer - Tamis - Siebeinsatz
6	NBR/EPDM/SIL /FKM	Guarnizione - Seal ring - Joint - Dichtring (NBR/EPDM/SIL/VIT)
7	Aisi 304/316	Attacco di uscita - Exit - Sortie - Ausgang Anschluss
8	Aisi 304/316	Girella - Nut - Ecrou - Nutmutter
9	Aisi 304/316	Corpo filtro - Body filter - Corp du filtre - Filter-Körper

Art. 96A

Filtro a 180° a saldare

180° filter - welding connections

Filtre droit a souder

Durchgangssieb 180° zum anschweiss

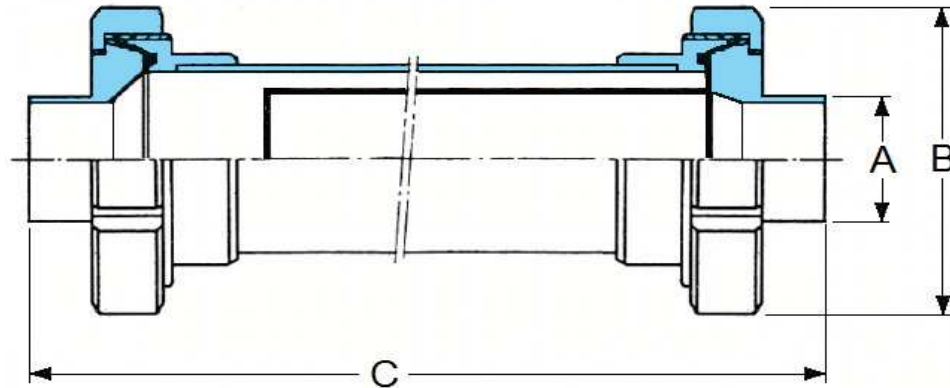

DN	1"	25	32	1½"	40	2"	50
A	25,4	28	34	38,1	40	50,8	52
B	112	112	112	112	112	112	112
C	361	361	361	361	361	361	361

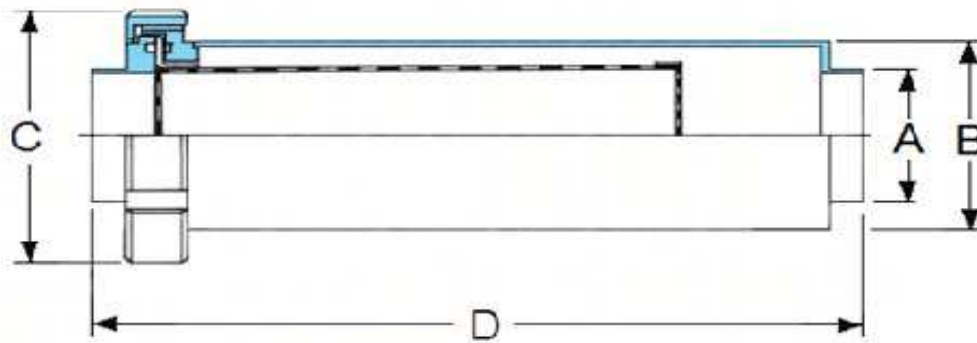

DN	60	2½"	65	3"	80	4"	100
A	60,3	63,5	70	76,2	85	101,6	104
B	114,3	114,3	114,3	114,3	129	129	129
C	148	148	148	148	178	178	178
D	372	372	372	372	470	470	470

Range di temp. Std, std range of temperature, temperature d'exercice std, std betriebstemperatur	-10° + 100°
Finitura std, std finishing, finissage std, std zurichten	Lucida est.- Satinata int. (Ra < 1,6 µ)
Filtraggio - Filtering - Filtration - Filtern	0,05 ÷ 10 mm
Posizionamento verticale	Positionnement vertical
Vertical positioning	Vertikale Positionierung